

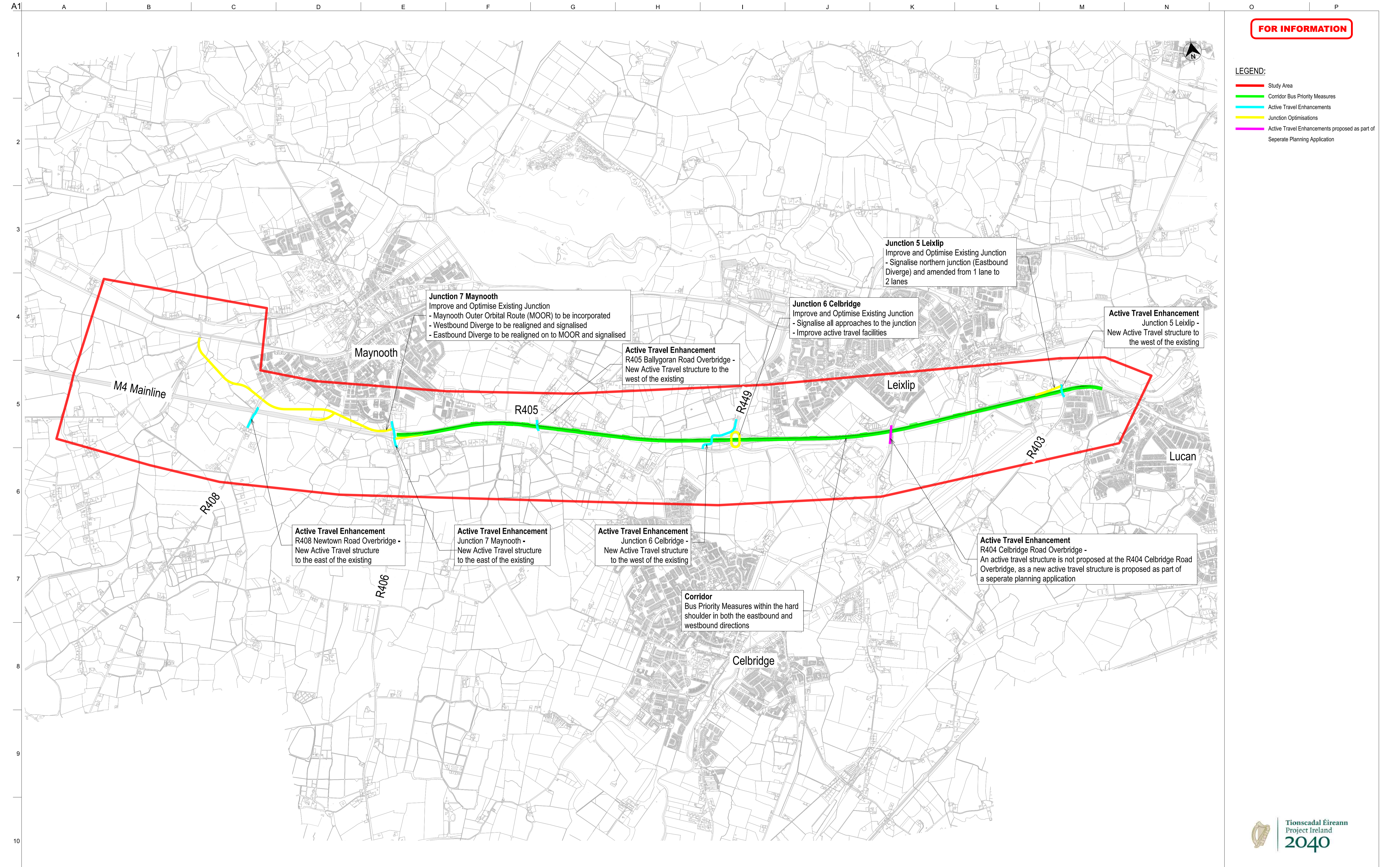

MAYNOOTH TO LEIXLIP PROJECT

## Preferred Options



**FOR INFORMATION**

- LEGEND:**
- Study Area
  - Corridor Bus Priority Measures
  - Active Travel Enhancements
  - Junction Optimisations
  - Active Travel Enhancements proposed as part of Seperate Planning Application

**Junction 5 Leixlip**  
 Improve and Optimise Existing Junction  
 - Signalise northern junction (Eastbound Diverge) and amended from 1 lane to 2 lanes

**Junction 7 Maynooth**  
 Improve and Optimise Existing Junction  
 - Maynooth Outer Orbital Route (MOOR) to be incorporated  
 - Westbound Diverge to be realigned and signalised  
 - Eastbound Diverge to be realigned on to MOOR and signalised

**Junction 6 Celbridge**  
 Improve and Optimise Existing Junction  
 - Signalise all approaches to the junction  
 - Improve active travel facilities

**Active Travel Enhancement**  
 Junction 5 Leixlip -  
 New Active Travel structure to the west of the existing

**Active Travel Enhancement**  
 R405 Ballygoran Road Overbridge -  
 New Active Travel structure to the west of the existing

**Active Travel Enhancement**  
 R408 Newtown Road Overbridge -  
 New Active Travel structure to the east of the existing

**Active Travel Enhancement**  
 Junction 7 Maynooth -  
 New Active Travel structure to the east of the existing

**Active Travel Enhancement**  
 Junction 6 Celbridge -  
 New Active Travel structure to the west of the existing

**Active Travel Enhancement**  
 R404 Celbridge Road Overbridge -  
 An active travel structure is not proposed at the R404 Celbridge Road Overbridge, as a new active travel structure is proposed as part of a seperate planning application

**Corridor**  
 Bus Priority Measures within the hard shoulder in both the eastbound and westbound directions



Notes

Clients



Key Plan

Consultant



Job Title  
 Maynooth to Leixlip Project



Scale at A1  
 1:20,000  
 Role  
 Civil - Highways  
 Date  
 January 2024

P01	17/01/2024	KD	GH	SB
Issued For Information (Status S2)				
Issue	Date	By	Chkd	Appd

Drawing Title  
**Stage 3 Preferred Options Overall Layout Plan Sheet 01 of 01**  
 Suitability  
**S2 - Suitable for Information**  
 Job No: 272691 Figure ID: Rev. P01  
 Drawing No: 272691-ARUP-02-CF-SK-Z-000040

1  
2  
3  
4  
5  
6  
7  
8  
9  
10



**FOR INFORMATION**

- Legend - Plan**
- Bituminous Road
  - Cut
  - Fill
  - Verge
  - Active Travel Facility
  - Buffer Line

- Notes:**
- Junction 5 Leixlip
- Improve and Optimise Existing Junction
  - Signalise northern junction Eastbound Diverge
  - Eastbound Diverge to be amended from 1 lane to 2 lanes

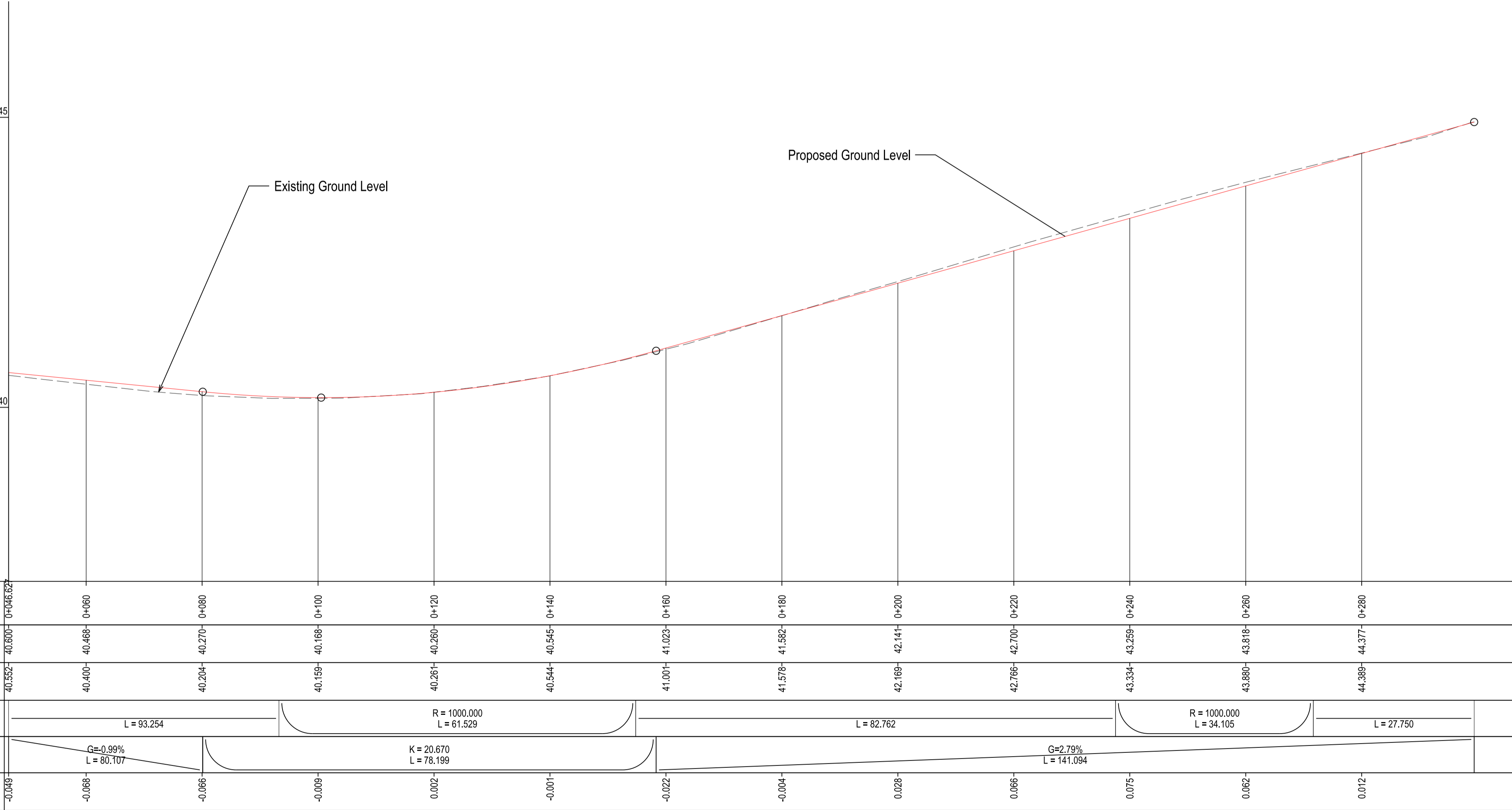

Notes

**Clients**

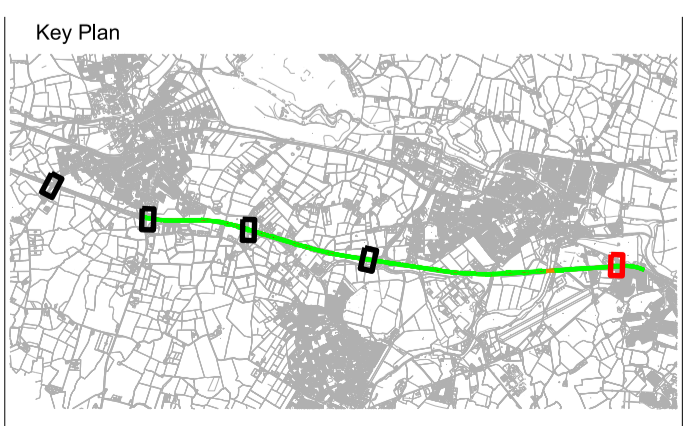

**Consultant**

One Albert Quay  
Cork, T12 X8N6  
Ireland

Tel +353 (0)21 422 5200  
www.arup.ie

**Job Title**  
Maynooth to Leixlip Project

Scale at A1  
**1:500**

Role  
**Civil - Highways**

Date  
**January 2024**

Issue	Date	By	Chkd	Appd
P01	17/01/2023	KD	GH	SB

**Drawing Title**  
J5 Preferred Option - EB Diverge  
Plan and Profile  
Sheet 01 of 01

**S2 - Suitable for Information**

Job No: **272691** Figure ID: **P01** Rev.:

Drawing No: **272691-ARUP-02-CF-SK-Z-000041**



**FOR INFORMATION**

**Legend - Plan**

- Stop Lines
- Signal Heads

**Notes:**

- Junction 6 Celbridge
- Improve and Optimise Existing Junction
  - Signalise all approaches to the junction
  - Improve all active travel facilities



**Notes**

**Clients**

**Key Plan**

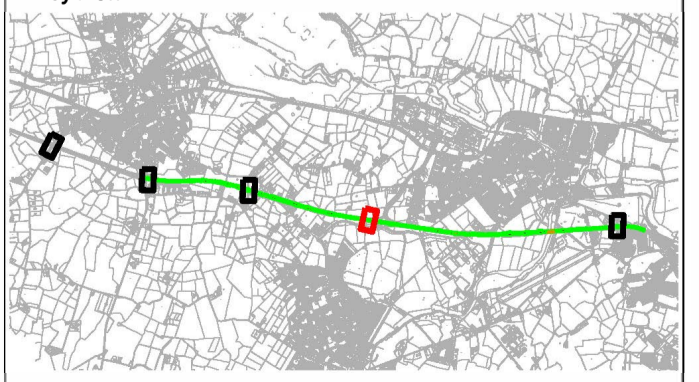

**Consultant**

Job Title  
Maynooth to Leixlip  
Project

Scale at A1  
1:1000  
Role  
Civil - Highways  
Date  
January 2024



P01	17/01/2024	KD	GH	SB
Issued For Information (Status S2)				
Issue	Date	By	Chkd	Appd

Drawing Title  
**J6 Preferred Option  
Signal Head and  
Stop Line Location**

Suitability  
**S2 - Suitable for Information**

Job No	Figure ID	Rev.
272691		P01

Drawing No  
**272691-ARUP-02-CF-SK-Z-000042**

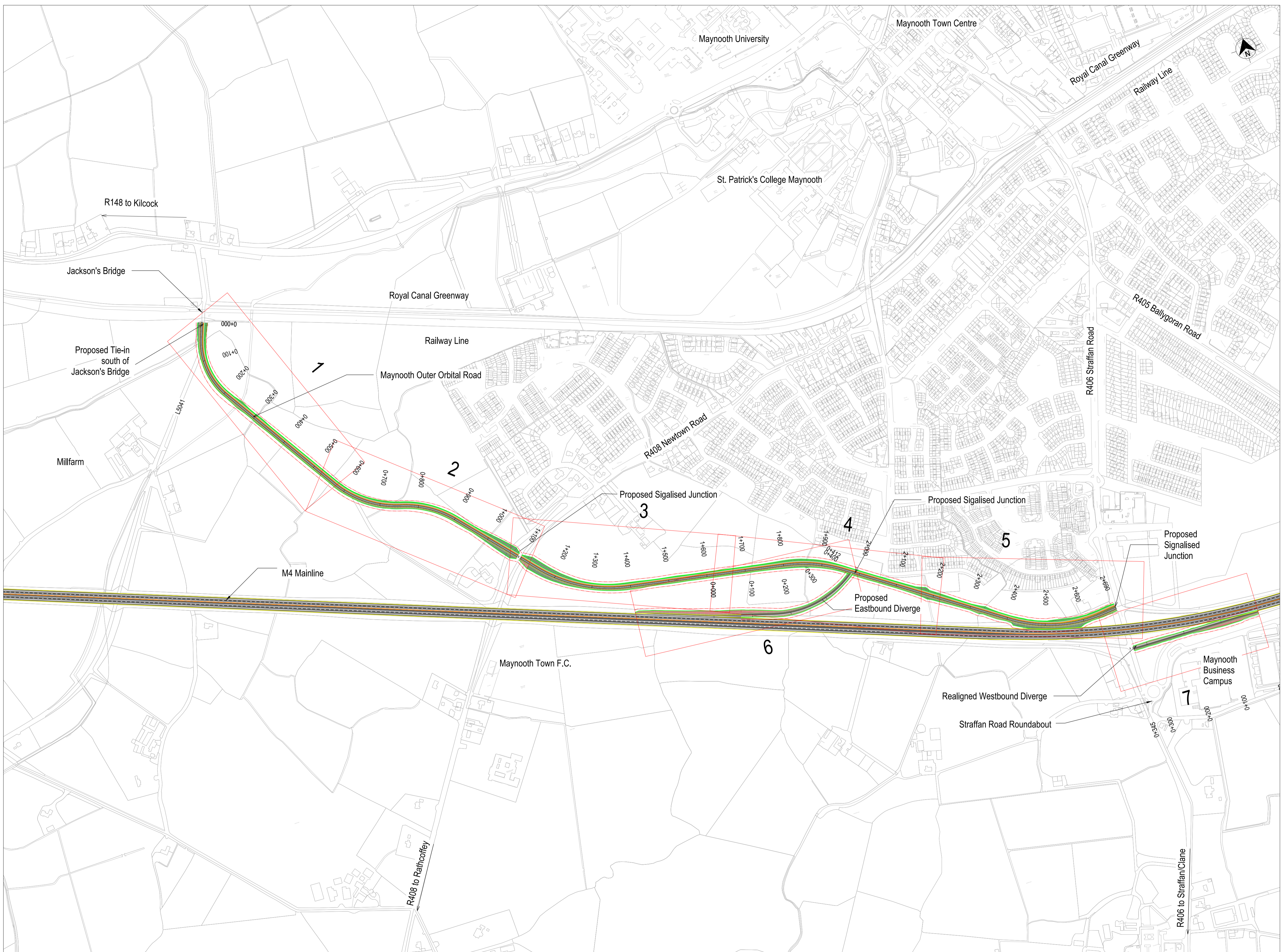

**FOR INFORMATION**

- Legend - Plan**
- Bituminous Road
  - Cut
  - Fill
  - Verge
  - Active Travel Facility
  - Buffer Line

- Notes:**
- Junction 7 Maynooth
  - Improve and Optimise Existing Junction
  - Westbound Diverge to be realigned and signalised
  - Eastbound Diverge to be realigned and signalised
  - Maynooth Outer Orbital Route (MOOR) to be incorporated.

Notes

Clients



Key Plan

Consultant



Job Title  
Maynooth to Leixlip Project



Scale at A1  
1:5000  
Role  
Civil - Highways  
Date  
January 2024

P01	17/01/2024	KD	GH	SB
Issued For Information (Status S2)				
Issue	Date	By	Chkd	Appd

Drawing Title  
**J7 Preferred Option Keyplan Sheet 01 of 01**

Suitability  
**S2 - Suitable for Information**

Job No 272691	Figure ID	Rev. P01
------------------	-----------	-------------

Drawing No  
272691-ARUP-02-CF-SK-Z-000043





**FOR INFORMATION**

**Legend - Plan**

- Bituminous Road
- Cut
- Fill
- Verge
- Active Travel Facility
- Buffer Line

**Cut Volumes:**  
 MOOR L5041-R408 - 4,420m<sup>3</sup>  
 MOOR R408-R406 - 8,226m<sup>3</sup>  
 EB Slip Road - 11,450m<sup>3</sup>  
 WB Slip Road - 2,513m<sup>3</sup>

**Fill Volumes:**  
 MOOR L5041-R408 - 7,138m<sup>3</sup>  
 MOOR R408-R406 - 17,466m<sup>3</sup>  
 EB Slip Road - 20m<sup>3</sup>  
 WB Slip Road - 70m<sup>3</sup>

- Notes:**
- Junction 7 Maynooth
  - Improve and Optimise Existing Junction
  - Westbound Diverge to be realigned and signalised
  - Eastbound Diverge to be realigned and signalised
  - Maynooth Outer Orbital Route (MOOR) to be incorporated

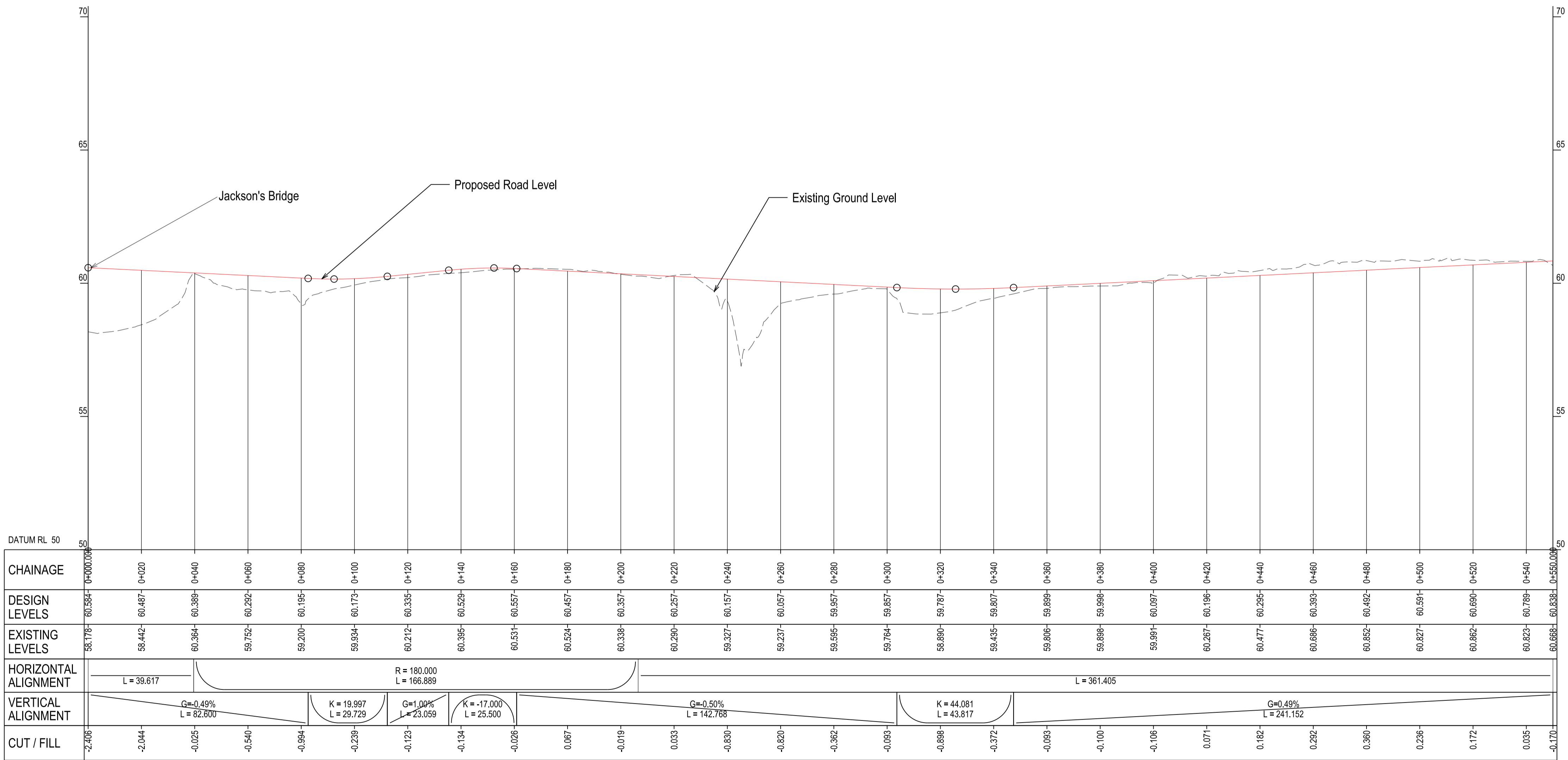

**Notes**

**Clients**

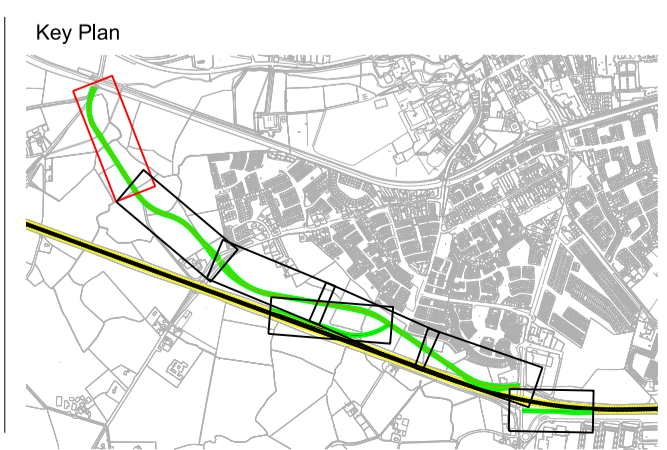

**Consultant**

One Albert Quay  
Cork, T12 X8N6  
Ireland

Tel +353 (0)21 422 5200  
www.arup.ie

**Job Title**  
Maynooth to Leixlip Project

**Scale at A1**  
1:1000

**Role**  
Civil - Highways

**Date**  
January 2024

Issue	Date	By	Chkd	Appd
P01	17/01/2024	KD	GH	SB

Issued For Information (Status S2)

**Drawing Title**  
J7 Preferred Option Plan and Profile Sheet 01 of 07

**Suitability**  
S2 - Suitable for Information

Job No:	Figure ID:	Rev.:
272691		P01

Drawing No: 272691-ARUP-02-CF-SK-Z-000044